

## Rolling Carts

## Assembly Instructions

AgileGo  
Magnet Cart  
(RMU101)



AgileGo  
VESA Cart  
(RVU101)



### **Important:** Read before Installation

Thank you for your purchase with The Joy Factory!

The AgileGo Rolling Carts are designed for long lasting performance, providing the user complies with assembly and maintenance procedures. This instruction manual is to help you get the best performance of the carts. The Joy Factory is not responsible for any damage as a result of (but not limited to) abuse and other malfunctions by a direct or indirect cause of failure to comply with the instructions provided in this booklet.

Please contact us at 1-877-JOY-FACT or 1-877-569-3228 with any installation questions.

## Contents

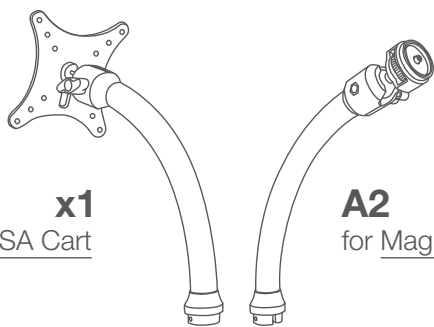

**A1** x1  
for VESA Cart

**A2** x1  
for Magnet Cart

**B** x1

**C** x1

**D** x5

**E** x1

**F** x2

**G** x2

**H** x2

**I** x1

**J1** (M5\*16) x4  
**J2** (M5\*12) x4  
for VESA Cart Only

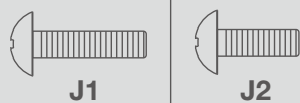

**K** x4  
for VESA Cart Only



## Tools required

T25 Star Screwdriver

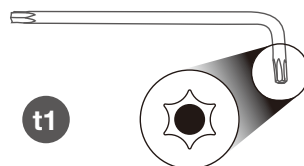

8mm Allen Wrench

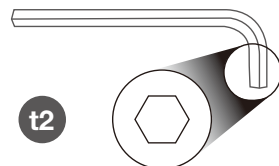

## Optional Accessories

(not included in the package)

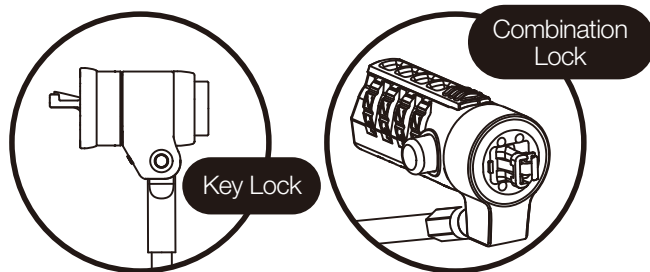

Security Cable (SCU101 / SCU102)

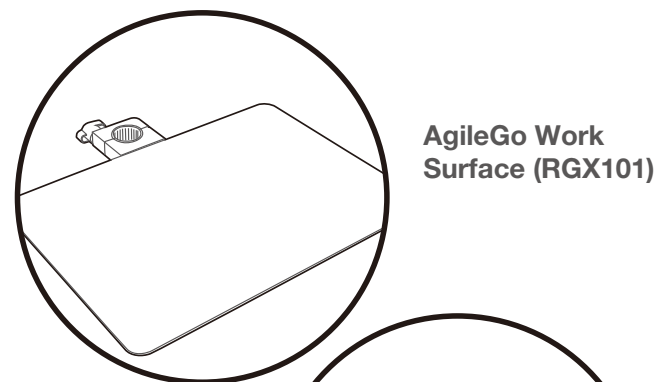

AgileGo Work Surface (RGX101)



AgileGo Basket (RGX102)

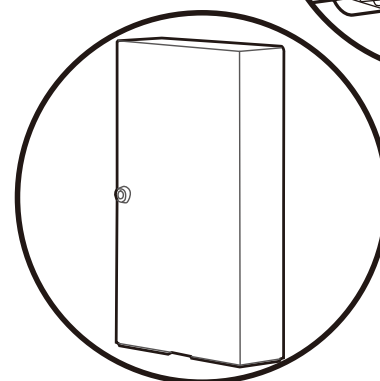

AgileGo Power Hub Holder (RGX103)

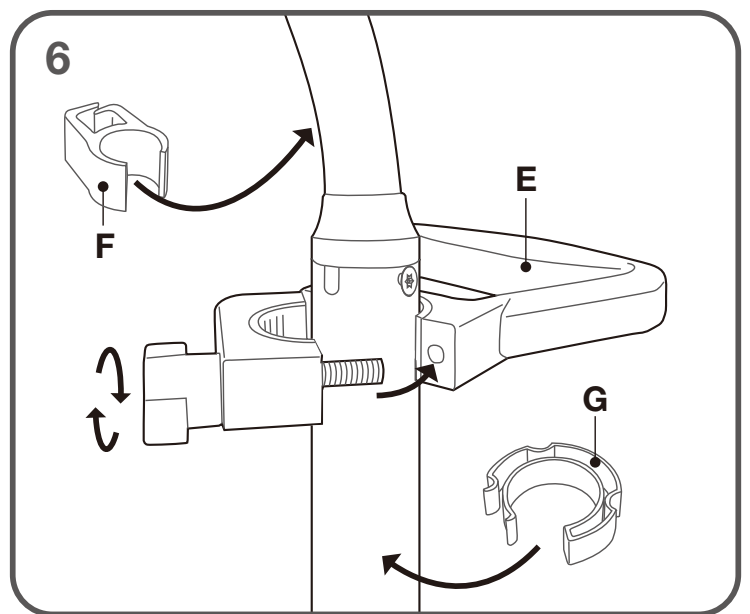
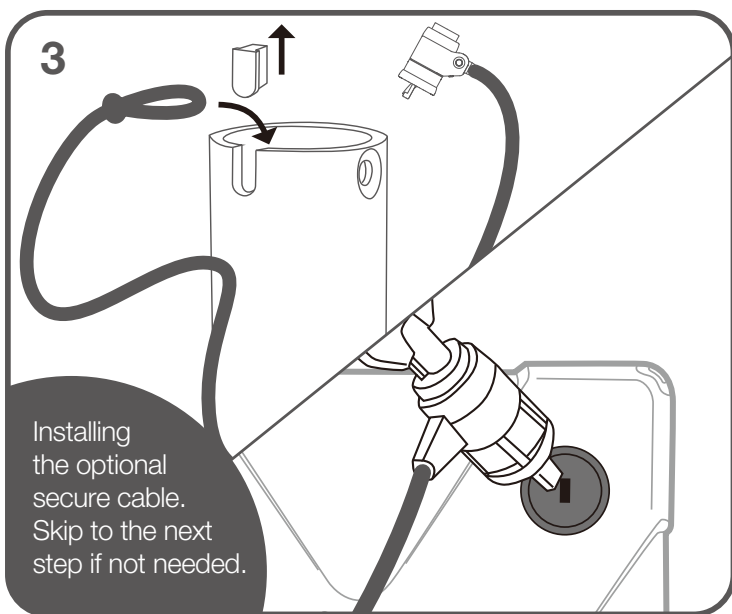
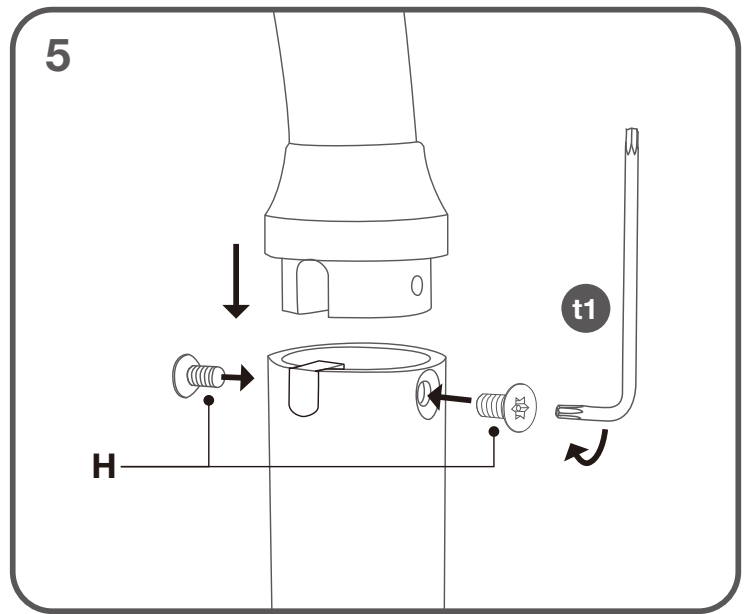
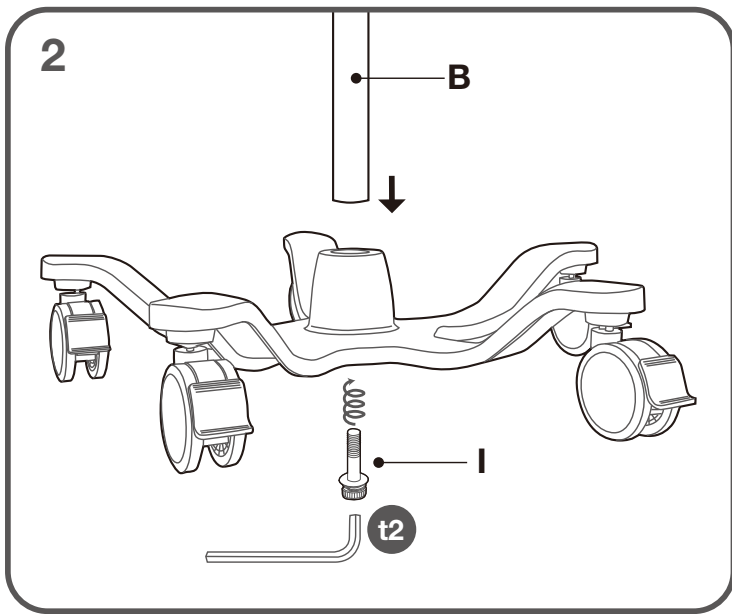
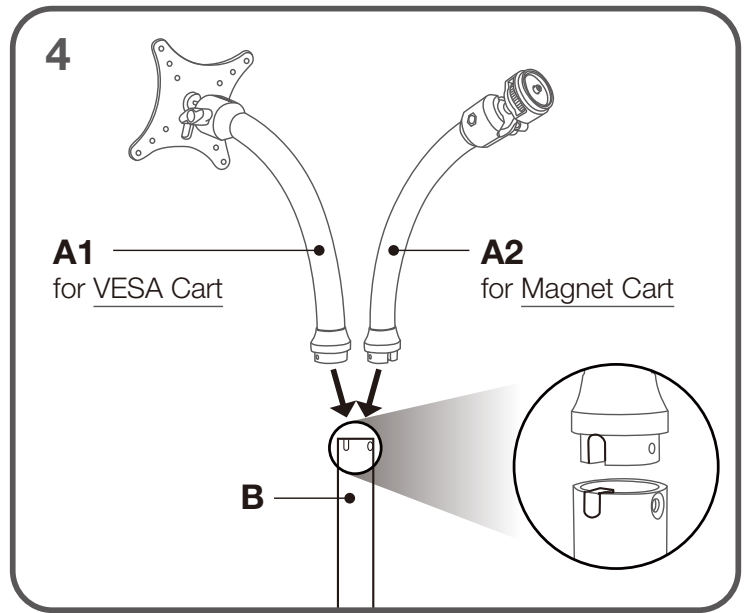
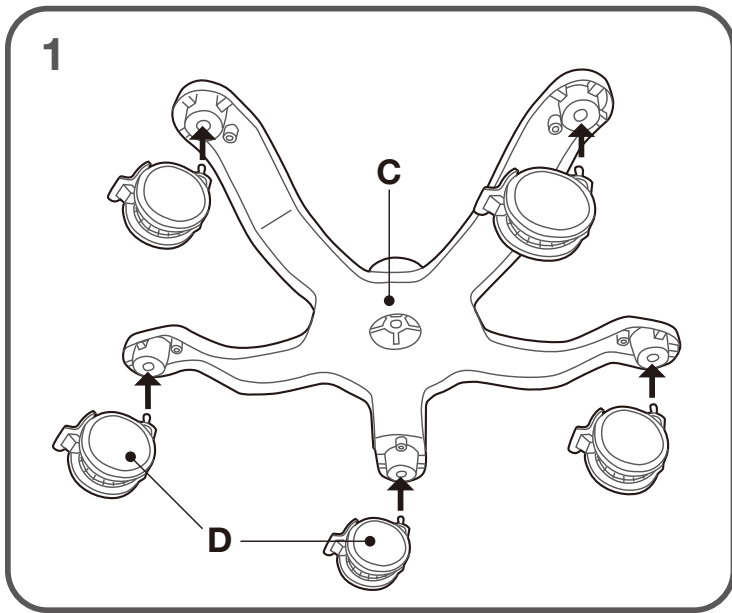

## AgileGo VESA Cart (RVU101)

### Install Enclosure

Enclosures not included

- ❶ for ABS Enclosure
- ❷ for Aluminum Enclosure
- ❸ for aXtion Pro Case

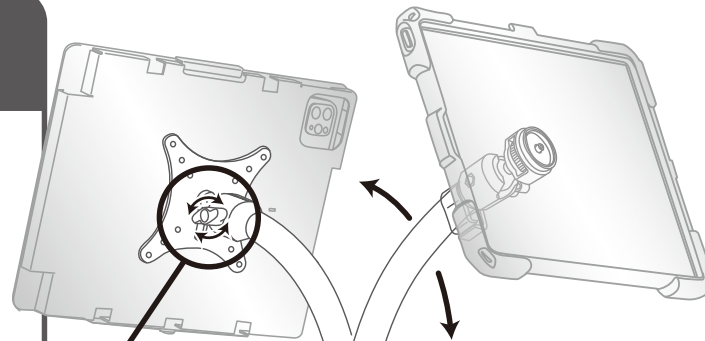
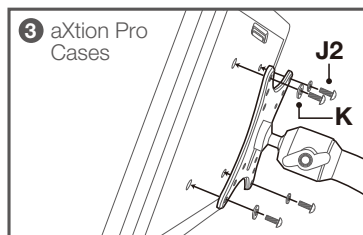
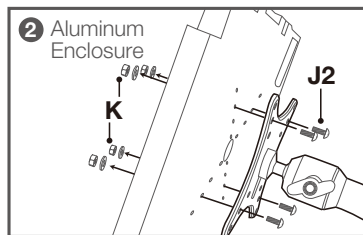
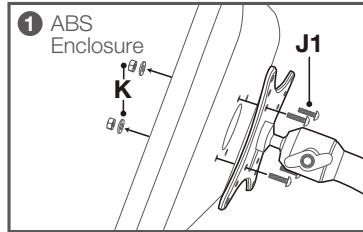

Adjust the case / enclosure to a preferred angle

## AgileGo Magnet Cart (RMU101)

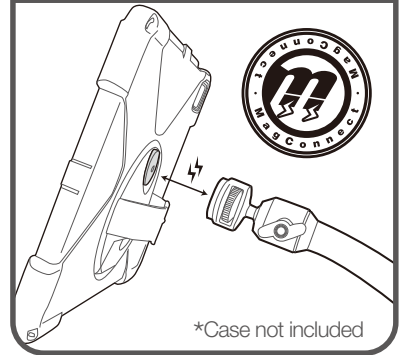

Adjusting the height and direction of the Flex Arm

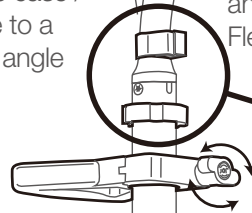

Optional AgileGo Work Surface (RGX101)

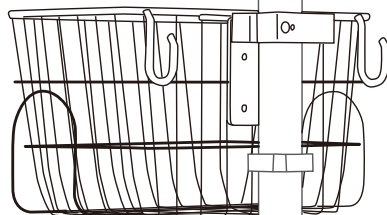
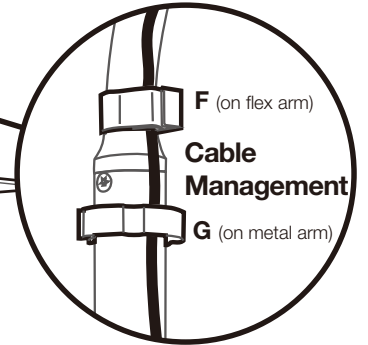

Optional AgileGo Basket (RGX102)

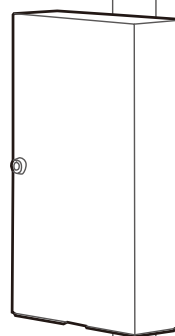

Optional AgileGo Power Hub Holder (RGX103)

Maximum Weight Capacity of the Arm:  
**up to 6 lbs**

Maximum Weight Capacity of the Cart:  
**up to 30 lbs**

# AgileGo™

## Rolling Carts

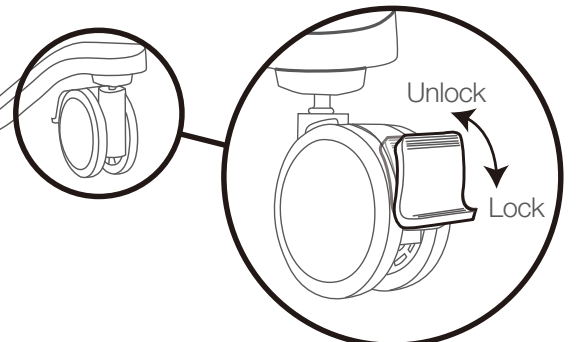
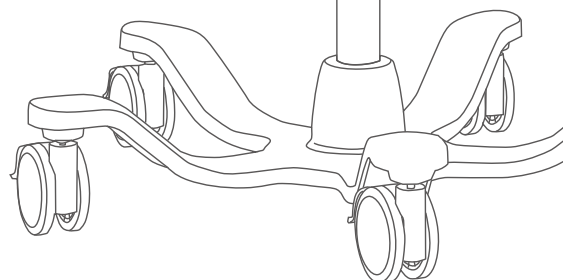

## Safety Instruction

Exceeding Maximum Weight Capacity of the arm and cart can result in severe personal injury or damage to your device. It is the user's responsibility to ensure the overall weight of all components do not exceed the maximum weight capacity.

Do not place any cart on an inclined surface greater than 10 degrees or it may tip.

Always put the casters in the lock position when the cart is not in use to prevent unexpected movement.

## Routine Maintenance

It is recommended to perform regular maintenance every three (3) months on all screws to ensure they are tightened. Visually inspect the cart for signs of wear.

## Troubleshooting

Problem	Solution
Ball joint not holding position	Ensure the mounted device does not exceed the 6 lb. weight capacity. Then ensure all knobs are securely tightened.
Flex arm not holding position	Ensure the mounted device does not exceed the 6 lb. weight capacity.
Handle is loose	Ensure knob is securely tightened.
Rolling cart is difficult to move	One or more casters might be locked. Ensure locks are in the up (unlock) position.
Rolling cart moves when it should not	One or more casters might be unlocked. Ensure locks are in the down (lock) position.

## Cleaning Instruction

It is important to disinfect the AgileGo rolling cart; including the base, stand, handle, and arm regularly. The most common and effective way to clean the rolling cart is using medical-grade disinfectant wipes.

For best results always test cleaners on a small discrete area of the cart before

cleaning its entirety. Intrusive or abrasive materials should never be used.

Follow the disinfectants cleaning instructions to ensure proper usage and handling. Contact us at 1-877-JOY-FACT or 1-877-569-3228 when there is any question about cleaning.

## Limited Warranty

The Joy Factory, Inc. warrants to the original purchaser of AgileGo rolling carts against defects in materials and workmanship for the period of 5 years.

The warranty period commences on the date of purchase from the authorized reseller/retailer or directly from The Joy Factory, Inc. web store. A proof of purchase is required for warranty service. The purchase invoice or receipt may be used as long as the purchase date can be verified. The Joy Factory at its discretion will repair or replace any part that The Joy Factory determines to be defective.

This warranty does NOT cover cosmetic damage. This warranty does NOT cover damage due to: acts of God; accident; misuse; abuse; neglect; modification; improper operation; improper maintenance; lack of maintenance; connection to improper equipment; or repairs conducted by a party other than THE JOY FACTORY, INC. This warranty does NOT cover products sold AS IS

or WITH FAULTS. The Joy Factory will not be liable for any indirect, incidental, or punitive damages arising from use of this product.

### Warranty Service

For warranty service within the warranty period, please contact The Joy Factory, Inc. support department to obtain a Return Merchandise Authorization (RMA) number. When returning the product, you must ship the product pre-paid and in its original packaging or in packaging that provides an equivalent degree of protection for the product during shipment. Place a copy of your proof of purchase inside the packaging and clearly mark the RMA number on the outside of the package. Return requests that do not contain an RMA number will not be processed. The Joy Factory, Inc. will ship the repaired or replaced product to you postage paid.



[www.thejoyfactory.com](http://www.thejoyfactory.com)

Email us at [support@thejoyfactory.com](mailto:support@thejoyfactory.com) or  
call us at +1(949) 216-8888